

Liikumisandur HYTRONIK RF HC018V 0-10V (LH3913)

tootekood: LH3913
 bränd: [HYTRONIK](#)
 toide: 230V
 korpuse materjal: plastik
 töökeskkond: sisse
 sertifikaadid: CE
[tootja koduleht](#)
 garantii: 5 aastat

hind: €35,83+KM
 hind: €43,00 koos km
 Soodushind: €29,17 + KM
 1-10V juhtimise võimalus, kolme
 astmeline timmerdamine, eraldi nupu
 lülitus

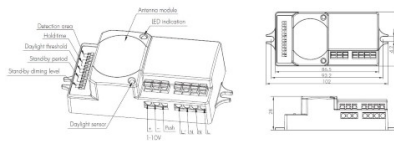
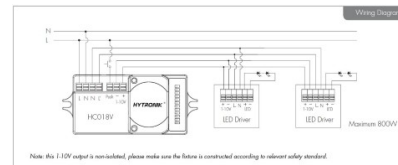

3-level Control (Corridor Function)

Hytronik builds this function inside the motion sensor to activate in level control, for some areas which require a light change notice before switch-off. The sensor offers 3 levels of light: 100%-dimmed light=off, and 2 periods of selectable waiting time: motion hold-time and standby period. Selectable daylight threshold and freedom of detection areas.

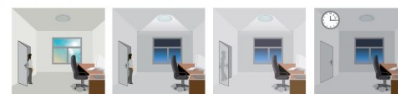

With sufficient natural light, the light does not switch on when presence is detected.
 With insufficient natural light, the sensor switches on the light automatically when presence is detected.
 After hold-time, the light dims to standby level or switch off if the standby period is pre-set to 0s.
 Light switches off automatically after the standby period elapses.

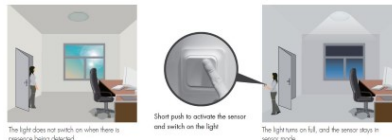

The light does not switch on when there is presence being detected.

Short push to activate the sensor and switch on the light

The light turns on full, and the sensor stays in sensor mode.



The light keeps being ON during the presence.

People left, the light dims to standby level after the holdtime.

The light switches off automatically after the standby period elapses.